

## Single axial PE accelerometer



### Features

- Miniature Size
- Adhesive or stud mounting
- Hermetic seal
- Annular shear mode
- Wide frequency response

### Application

- Vibration monitoring
- Shock testing
- Road testing
- Modal analysis
- Aircraft testing

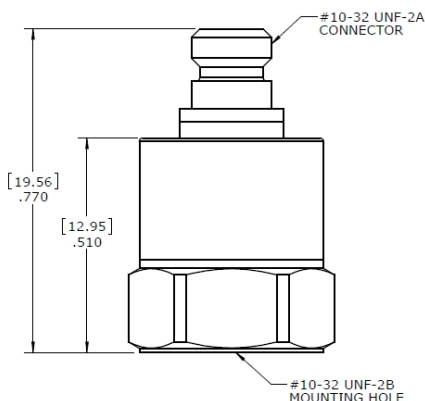
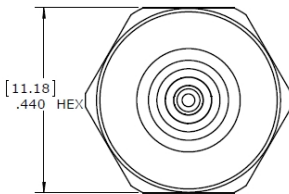

### Dynamic

Sensitivity, $\pm 20\%$ , 25°C.....	6 pC/g
Acceleration range .....	2000 g peak
Amplitude nonlinearity.....	1%
Frequency response:	
± 5%.....	1 - 7,000 Hz
±1dB.....	1 - 10,000 Hz
± 3 dB.....	0.5 - 15,000 Hz
Resonance frequency.....	40 kHz
Transverse sensitivity, max.....	5% of axial
Temperature response:	
-50°C.....	-5%
+125°C.....	+5%

### Electrical

Electrical noise, Broadband Spectral(g):	
1 Hz to 10 kHz.....	100 $\mu$ g
Grounding.....	Case grounded

### Environmental

Temperature range.....	-50 to 125°C
Vibration limit.....	2000 g peak
Shock limit.....	5,000 g peak
Electromagnetic sensitivity, equiv g, max .....	70 $\mu$ g/gauss
Sealing .....	Hermetic
Base strain sensitivity, max.....	0.0002 g/ $\mu$ strain

### Physical

Sensing element design.....	PZT ceramic/shear
Weight.....	7 grams
Case material.....	Stainless Steel
Output connector.....	10-32

### Accessories

- Mounting stud
- Calibration certificate

### Option

Mounting stud: 10-32 to M5(-B), 10-32 to 10-32(-A), or custom(-C)

Mating cable with BNC output: 11P-L

Mating cable with 10-32 connector output: 10P-L

Note: Frequency response limits spectral and noise values are typical

### Ordering Information

