

## LVDT position transducer

Sensitivity,  $\pm 10\%$ ,  $24^{\circ}\text{C}$ ..... 100 mV/V/mm  
 Measuring range(mm) .....  $\pm 1.27$   
 Nonlinearity(@50% Stroke)..... <0.15% Max.  
 Nonlinearity(@100% Stroke)..... <0.25% Max.

### Electrical

Power excitation(@2.5KHz) ..... 3 Vrms  
 Output Impedance..... <100  $\Omega$   
 Insulation resistance(@500Vdc)..... >10 M $\Omega$   
 Null voltage..... <0.5% FSO  
 Repeatability..... <0.15%  
 Output at stroke ends..... 127 mV/V

### Environmental

Temperature range.....  $-55$  to  $125^{\circ}\text{C}$   
 Operation humidity..... <85% R.H  
 Shock limit..... 1,000 g peak  
 IEC 60529 rating..... IP61

### Physical

Sensing element..... LVDT  
 Output cable(32# AWG)..... 0.4m PFA Insulation  
 Case material..... Stainless steel

### Accessories

Calibration certificate



### Features

- High Resolution
- High output signal
- Shock resistant
- Compact size
- Light weight
- Reliability package

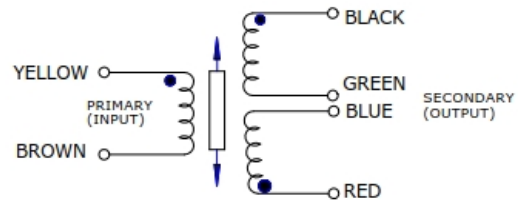

**WIRING SHECMATIC**  
 CONNECT GRN&BLU FOR  
 DIFFERENTIAL OUTPUT

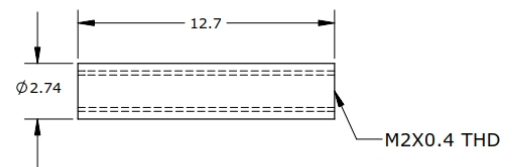

**CORE**

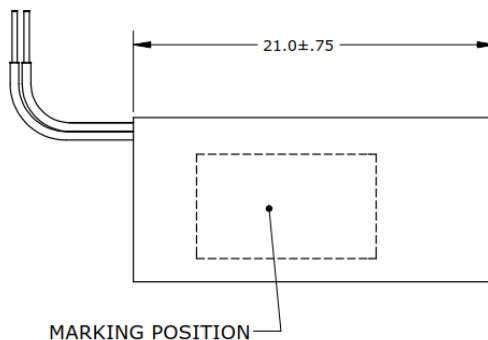
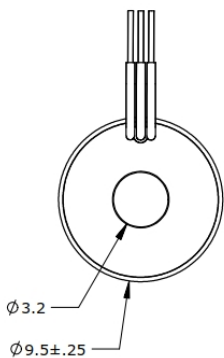

**LVDT**

### Ordering Information

