

Water proof industrial vibration sensor



Features

- Water proof
- Side integrated cable
- Shock resistance
- Wide frequency response
- High sensitivity
- Hermetic seal
- Case isolated
- EMI / RFI shielded

Application

- Railway detection
- Gear box monitoring
- Bearing detection
- Machine monitoring

Description

Model 341A is an water proof IEPE accelerometer permitting vibration measurements. 341A features an annular shear ceramic crystal which exhibits excellent output stability over time. The accelerometer incorporates an internal circuit with in a two-wire IEPE system which transmits its low impedance voltage output through the same cable that supplies the constant current power. Signal ground is internal shielded and isolated from the outer case of the unit. Polarity inversion protection for the amplify circuit is inherent in the circuit design. The welded stainless-steel construction provides a hermetic housing. Internal glass insulated connector provides long-term stability over the operating temperature range. Side outlet cable enable the compact installation and discretional cable direction. In addition to adhesive mounting, 341A has $\varnothing 6.4$ through holes for screw mounting on the test object. The 341A provides wide frequency response and shock resistance, which is ideal for industrial vibration monitoring under incidental shock environment.

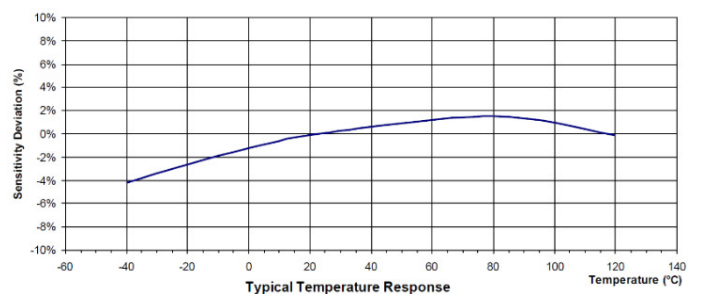
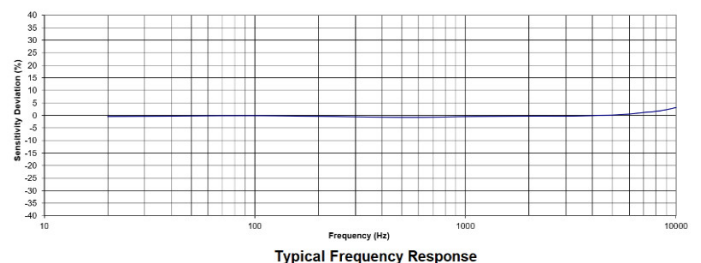
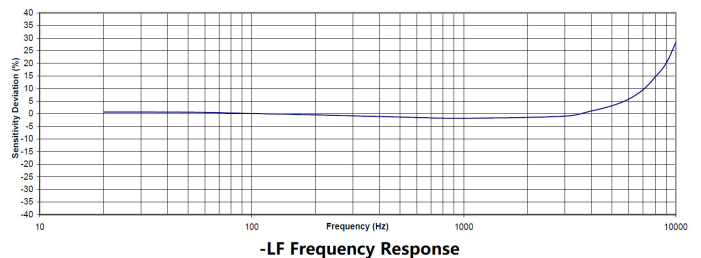
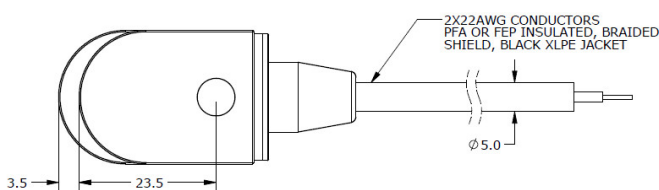
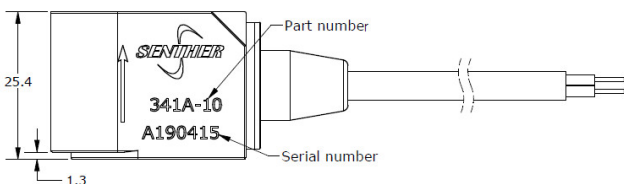
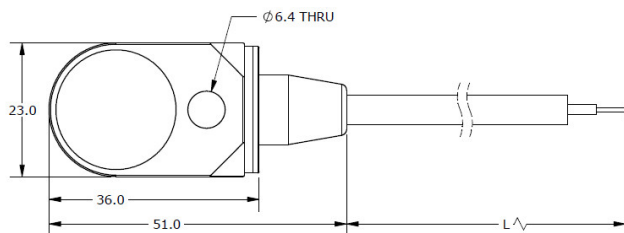

Specification

Typical at +24°C (+75°F), 24Vdc, 4 mA and 100Hz, unless otherwise stated.

Part Number	341A-5-LF	341A-10-LF	341A-10	341A-20	341A-80	341A-500	
Dynamic Range	±5	±10	±10	±20	±80	±500	g, peak
Sensitivity ±10%	1000	500	500	250	100	10	mV/g
Freq. Resp. ±5%	0.6-3000	0.6-3000	1-3000	1-6000	1-6000	1-6000	Hz
Freq. Resp. ±3dB	0.1-5000	0.1-5000	.3-5000	.3-8000	.3-8000	.3-8000	Hz
Resonant Frequency	18	18	25	25	25	25	kHz
Transverse Sensitivity	<5	<5	<5	<5	<5	<5	%
Temp. Resp., -55 to +125°C	±10	±10	±10	±10	±10	±10	%
Non-Linearity	±1	±1	±1	±1	±1	±1	%FSO
Residual Noise	0.00015	0.0002	0.0005	0.0005	0.0005	0.0010	g RMS
Shock Limit	2000	2000	2000	5000	5000	5000	g
Warm-up Time	<5	<5	<2	<2	<2	<2	second
Weight(cable excluded)	117	117	110	110	110	110	Gram

Specifications	Standard	Units
Bias Voltage	10 to 14	Vdc
Supply Voltage	18 to 30	Vdc
Supply Current	2 to 10	mA
Output Impedance	<100	Ω
Case Insulation (@100Vdc)	>100	MΩ
Operating Temperature	-55 to +125°C	°C
Humidity	Hermetically Sealed	
Case Material	316L Stainless Steel	
Sensing Element	Piezo Ceramic (Shear)	
Connector	2 Pin MIL-C-5015	

Accessories

Calibration certificate included.

Part Number	Description	Availability
PM0118	¼-28x1¼ hex head mounting screw	One screw Included
PM0333	M6x35 hex head mounting screw	
MB0004	341A magnet mounting adapter	Optional
IN-03	3 channels IEPE signal conditioner	Optional
IN-91	Portable vibration analyzer	Optional
IN-SDG	8 channels data acquisition system	Optional

Measurement configuration



Ordering information

341	A	-	80	-	LF	-	B	-	3
Model	Output signal	-	Range	-	Low frequency option	-	Mounting stud	-	Cable length
341	A=IEPE output	-	5=5g 10=10g 20=20g 80=80g 500=500g	-	LF= Low frequency Blank= Standard FR	-	A= 1/4-28 mounting screw B= M6 mounting screw C*=Special	-	3=3 meters



Senter reserves the right to make changes to any products or technology herein to improve reliability, function or design. Senter does not assume any liability arising out of the application or use of any product or circuit described herein; neither does it convey any license under its patent rights nor the rights of others.